

# Nasopharyngeal Specimen Collection

## COVID-19 Testing with SARS-CoV-2-RNA, Qualitative Real-Time RT-PCR

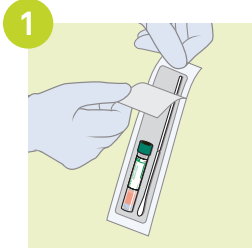

The test has not been FDA cleared or approved or authorized. The test has been validated according to CLIA, but the FDA's independent review of this validation is pending.



**1** **Open the individual collection package** that contains the swab and Viral Transport Medium tube. Set the tube aside before beginning to collect the specimen.

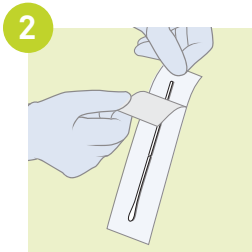

**2** Open the collection swab wrapper by peeling open the top of the wrapper.  
**Remove the swab**, taking care not to touch the tip of the swab or lay it down.

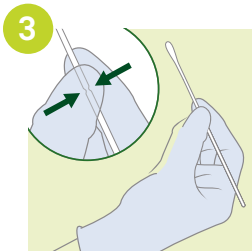

**3** **Hold the swab in your hand**, placing your thumb and forefinger in the middle of the swab shaft across the scoreline.



**4** **Gently insert the swab** into the nostril. Keep the swab near the septum floor of the nose while gently pushing the swab into the post nasopharynx.

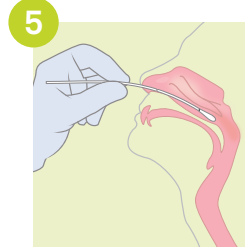

**5** As a visual reference, the swab should be inserted about half the distance from the opening of the patient's nostril and the ear.  
**Rotate the swab** several times.

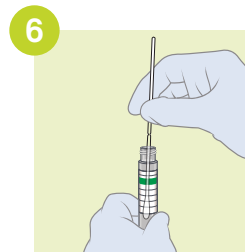

**6** While holding the swab in the same hand, aseptically remove the cap from the tube.  
**Insert the swab into the tube** with the transport medium.

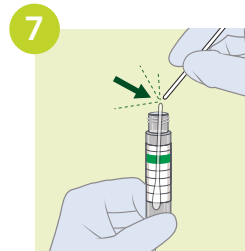

**7** Identifying the scoreline, **break the swab shaft** against the side of the tube. If needed, gently rotate the swab shaft to complete the breakage.  
**Discard the top portion** of the swab shaft.

**Discard the top portion** of the swab shaft.

Avoid splashing contents on the skin. Wash with soap and water if exposed.

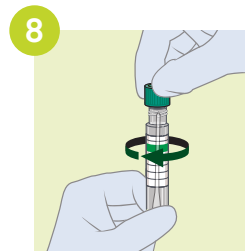

**8** **Replace the cap** onto the tube and close tightly.

Samples should be shipped frozen (preferred). However, samples can be shipped refrigerated at 2 °C–8 °C, and are stable at this temperature for 72 hours. Cold packs/pouches must be used if placing specimens in a lockbox for courier pick-up. Specimens should be shipped overnight to your local Quest Diagnostics accessioning laboratory according to standard operating procedures. SARS-CoV-2 RNA, Qualitative Real-Time RT-PCR test is not a STAT test and STAT pick-up cannot be ordered.