

InteliChart Version 3.5.22

On Friday, **February 17, 2023**, your InteliChart Patient Portal environment will be upgraded to version 3.5.22. The portal will be unavailable between 9:00 pm EDT to 9:00 am EDT the following morning. Please be aware, the InteliChart Patient Portal may be unavailable intermittently during the weekend to complete validation of the portal upgrade and additional work.

Enhancements - Practice Portal

Adjust Allowed Message Character Limit

Practice Portal >
Portal Management >
Patient Interface >
Manage Setup

In Manage Setup under “Allow Ability to Send Message”, there is a new setting where you are able to **adjust the number of allowed characters** that can be sent in a secure message **from** the Patient Portal. This allows you to control the size of the messages that can be sent by the patient.

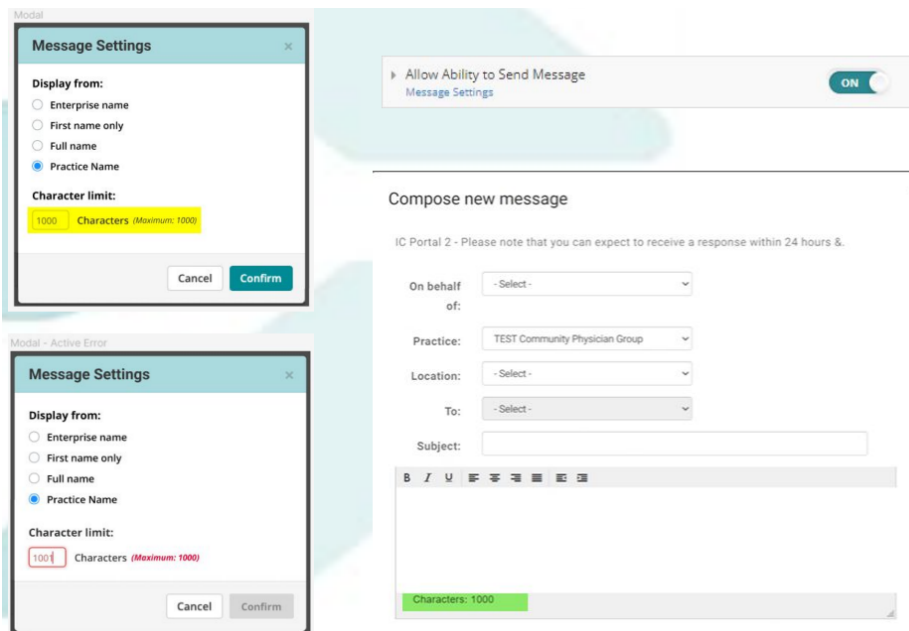

Enhancements - Patient Portal

Previous Address

Patient Account > My Chart > Summary

Prior addresses of the patient can now be seen by clicking on the **Previous Address** button in My Chart > Summary tab.

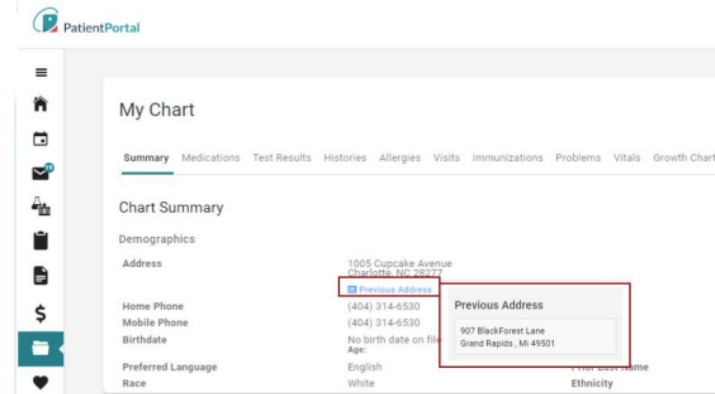

Message Disclaimer

Compose New Message

When a patient replies to a message in the portal, there is a new disclaimer that advises them to **type their response above the provider's message**. Previously, patients would type the message at the bottom of the reply, and messages were showing blank to providers.

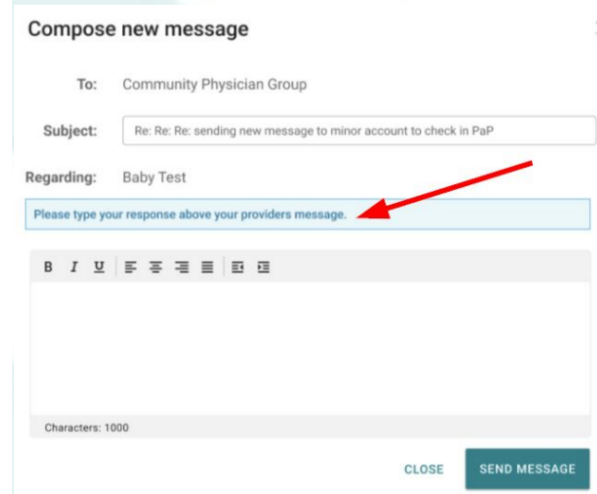

Growth Chart: Weight for Length

Patient Account > My Chart > Growth Charts

Weight for Length percentile measurements will now display as a growth chart for children under 36 months.

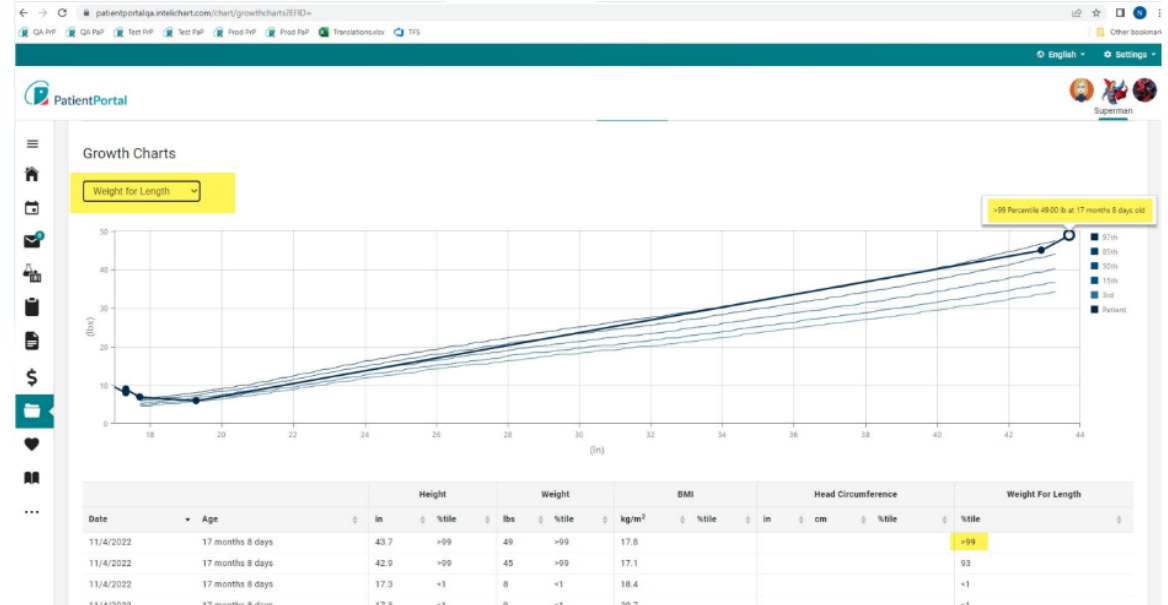

Mobile Responsiveness

Ongoing efforts to enhance the user experience with better screens, drop-down arrows, consistent back buttons, and other user-friendly navigation tools.