

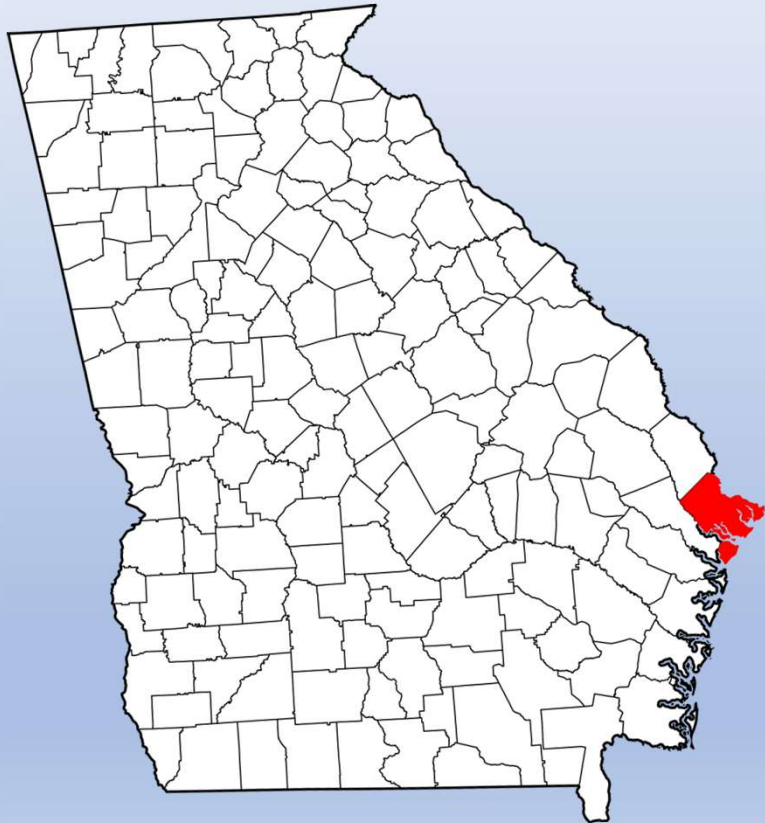

Chatham
County, GA

Chatham County



- Population 308,900
- Median Household Income \$69,575
- People Living Below Poverty Level 15.2%



Chatham County Vision & Mission

VISION: To make Chatham County, Georgia the best place to live, work, and play!

The mission of Chatham County Government is to protect and serve the public and provide essential services to improve the quality of life.

Department of Defense Facilities Within Chatham County



165th Airlift

Savannah
Combat
Readiness Center

US Army Corps of
Engineers-
Savannah District

Army Corps Dock
& Depot

Coast Guard
Station Tybee

Hunter Army
Airfield

National Guard
Armory

US Army DPTMS
Airfield Division

Army Reserve
Center

IMPACT BY UNIT

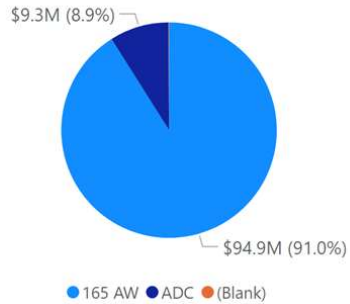

IMPACT FROM 165 AW BY SUBTYPE

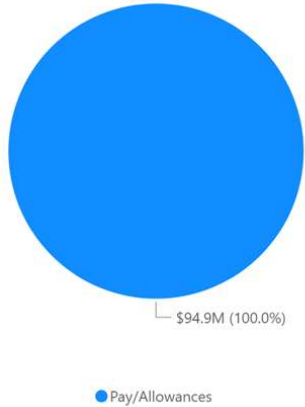

IMPACT BY TYPE

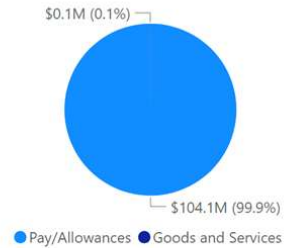

FY2024 ECONOMIC IMPACT BY TYPE

Type		165 AW	ADC	Total
Pay/Allowances	\$25,654	\$94,867,168	\$9,255,639	\$104,148,461
Goods and Services	\$52,617			\$52,617
Total	\$78,271	\$94,867,168	\$9,255,639	\$104,201,078

FY2024 ECONOMIC IMPACT BY SUBTYPE

SubType		165 AW	ADC	Total
Travel / Per Diem	\$25,654			\$25,654
Multiple	\$52,617			\$52,617
ADC Exercise Per Diem / Lodging			\$1,110,500	\$1,110,500
Civilian Pay		\$17,745,576	\$327,046	\$18,072,623
Reserve Military Pay		\$37,623,286	\$758,533	\$38,381,819
Active Military Pay		\$39,498,305	\$7,059,560	\$46,557,865
Total	\$78,271	\$94,867,168	\$9,255,639	\$104,201,078

1.7 ECONOMIC IMPACT MULTIPLIER

\$72,940,754

IMPACT FROM PAYROLL

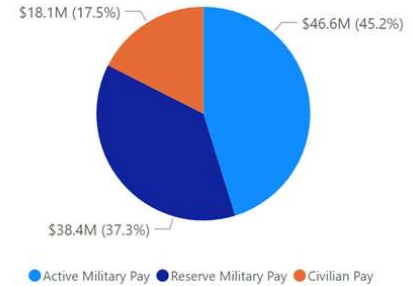

IMPACT FROM ADC BY SUBTYPE

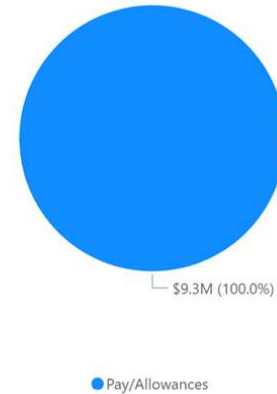



165 AW

Personnel

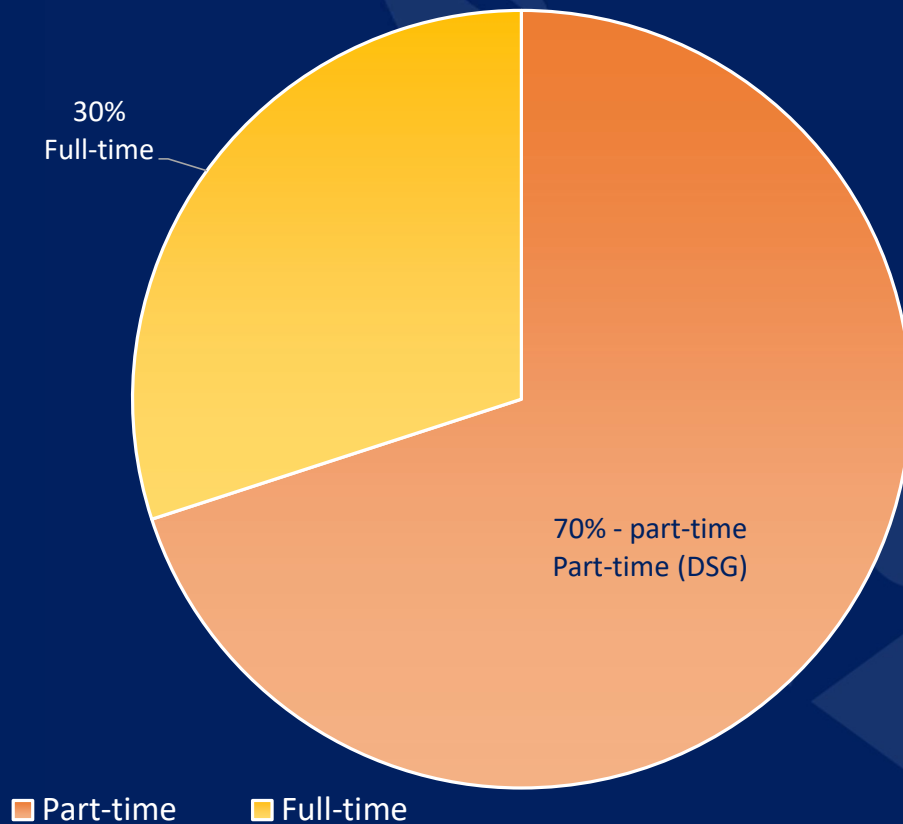

- **1343 Airmen**
 - 70% pull-time
 - 30% full-time
- **More than Georgia**
 - Florida
 - South Carolines
 - North Carolina
 - Alabama
 - Virginia
 - Oklahoma
 - Tennessee
 - Kentucky
 - Michigan



165 AW

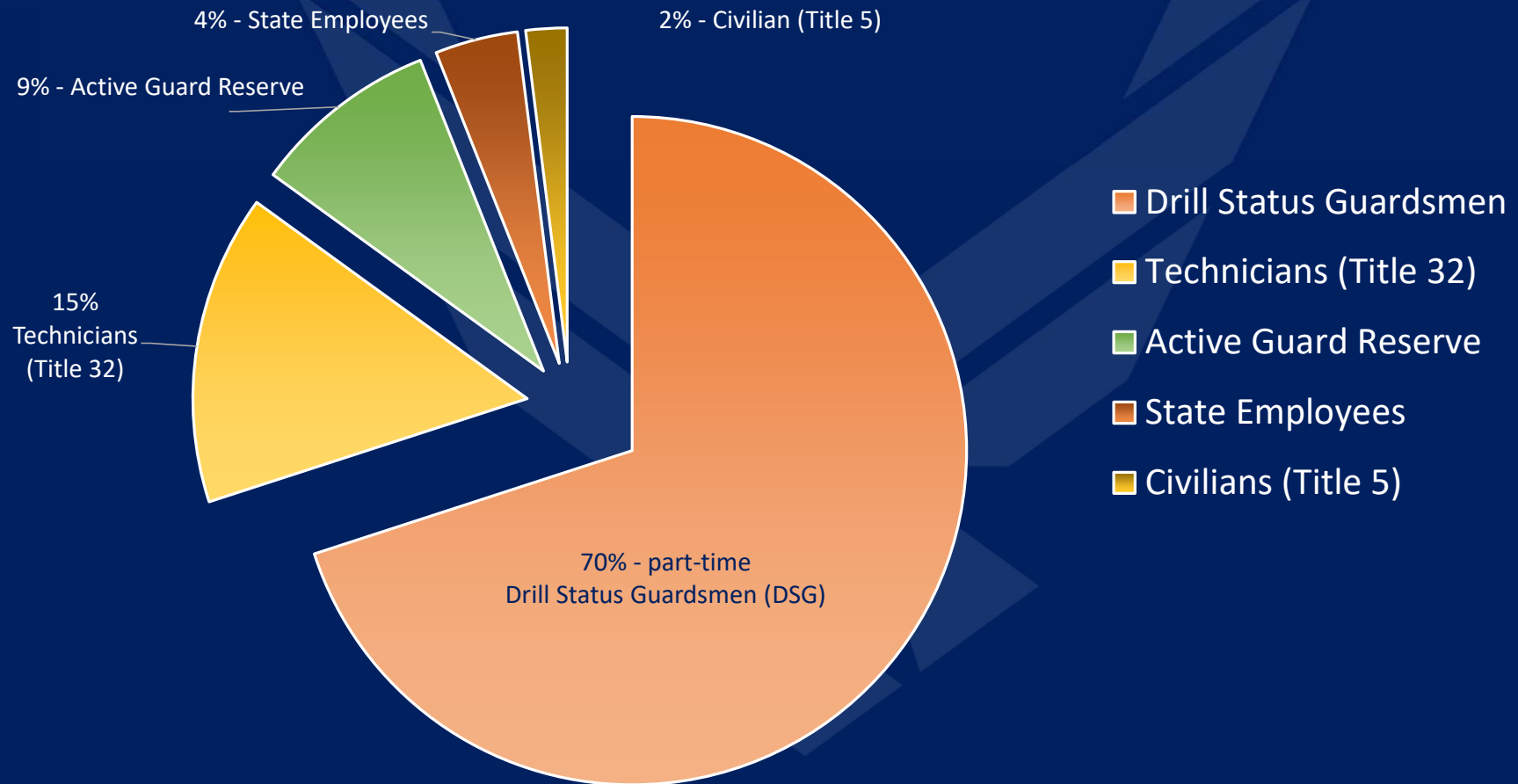

Coastal Georgia Military Affairs Council

- CGMAC Advocates for Coastal Georgia Military Support
- The primary objective is to advocate for the ongoing development and support of military activities, installations, personnel, and families in Coastal Georgia.
- Recent key topics included securing planning and design funding for key projects at Fort Stewart/Hunter Army Airfield, protecting the Coastal Regional Training Center (CRTC), and obtaining the last four C-130Js for the 165th Airlift Wing, that are currently in production.



Installation Support Efforts to Date



Chatham County Animal Services has an Intergovernmental Support Agreement with HAAF to assist with animal-related calls on post.



Chatham County engineering has a long-standing relationship with US Army Corps of Engineers for various drainage projects impacting citizens on and off base, as well as collaborative work on the Hutchinson Island boat ramp and Savannah Harbor Expansion Project.



Chatham County Mosquito Control has various agreements in place to support search and research efforts using FLIR camera with US Coast Guard and Air National Guard.



Chatham County Mosquito Control manages educational awareness and such as requested for mosquito borne disease activity in proximity to HAAF.



Chatham County is currently facilitating conversations with Chatham Area Transit for pilot program to assist soldiers and their families with access to transportation on and off base; during traditional and nontraditional work hours.

Threats in Chatham County

Natural Threats

- Hurricanes
- Wind Damage
- Storm Surge
- Tornadoes
- Flooding
- Lightning



Man-Made Threats

- Hazardous Materials
- Bomb Threats
- Explosions
- Chemical Exposure
- Biological Exposure
- Active Shooter
- Cybersecurity



Storm Surge: Category 5 Hurricane

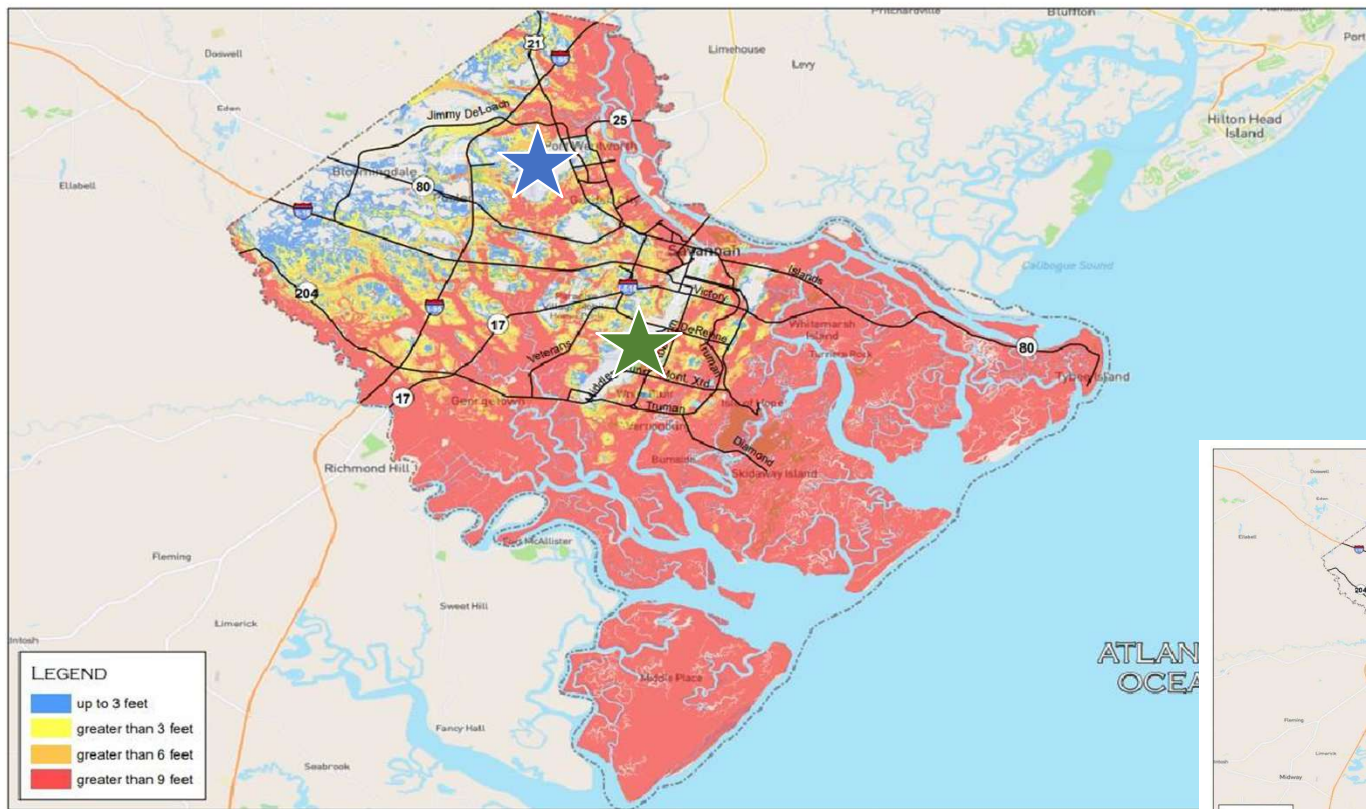

DATA: DERIVED OF 2021 STORM SURGE
BASED OFF THE 2016 LIDAR DATASET
MAP DATE: 08/04/2021
PRODUCED BY: DAVID ANDERSON

STORM SURGE 2021 - CATEGORY 5
CHATHAM COUNTY, GEORGIA

0 2 4

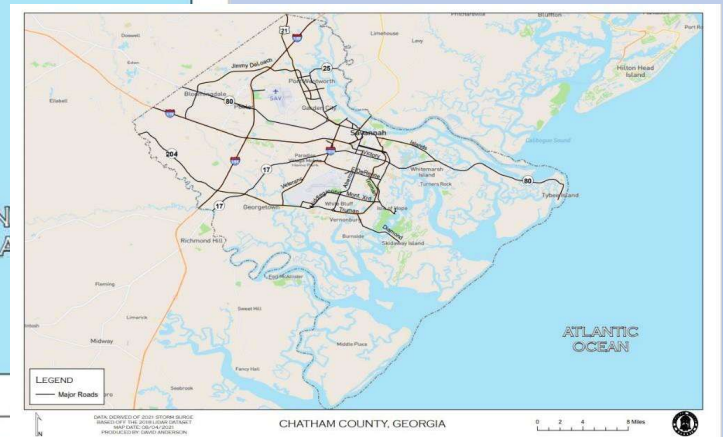

DATA: DERIVED OF 2021 STORM SURGE
BASED OFF THE 2016 LIDAR DATASET
MAP DATE: 08/04/2021
PRODUCED BY: DAVID ANDERSON

CHATHAM COUNTY, GEORGIA

0 2 4 6



Chatham County:
No Storm Surge

Community Infrastructure

- During a disastrous event, Chatham County plays a critical role in ensuring the resilience of services and logistics for all military installations through a coordinated efforts within the Emergency Operations Center, such as:
 - Communication
 - Debris management
 - Energy
 - Fire Fighting Services
 - Health and Medical Services
 - Law Enforcement
 - Mass Care and Sheltering
 - Resources and Logistics
 - Transportation



Chatham Current Emergency Operations Center

- Primary Facility located in the basement of the Old Courthouse
 - 72 available workstations
 - Physically separated over two floors and closed off section
 - No dedicated sleeping space available on site
 - 8 miles from the Dispatch Center
 - Basement has history of flooding
- Secondary Facility located at the Police Annex
 - 68 available workstations
 - No breakout rooms for Command Policy Group
 - Within same facility as Dispatch Center
 - Limited access for media
 - No available sleeping space dedicated on site

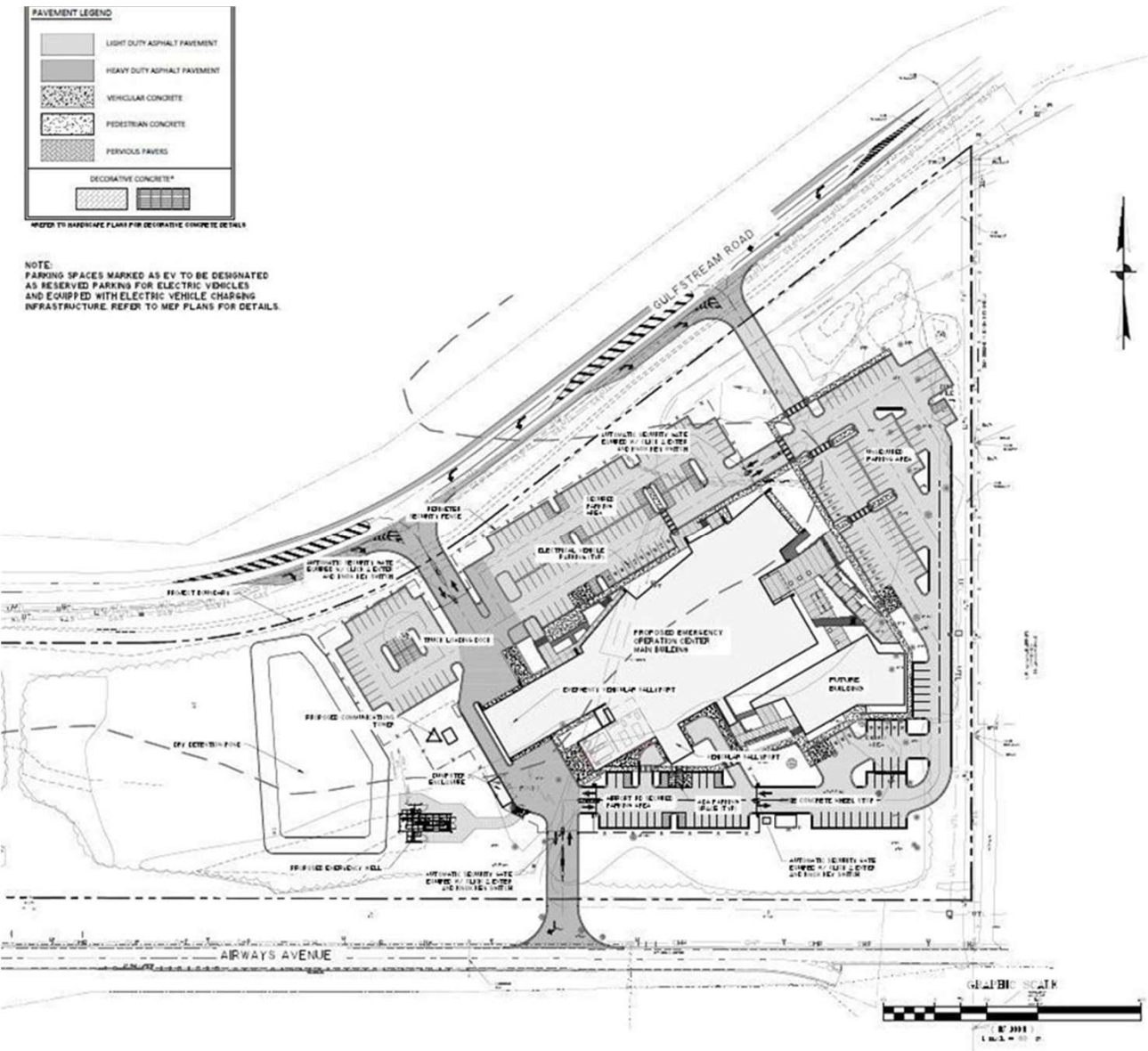

Facility Site

- Access to Savannah - Georgia Ports Authority
- Major Interstates: I-95 & I-16
- Major Railways: CSX & Norfolk Southern

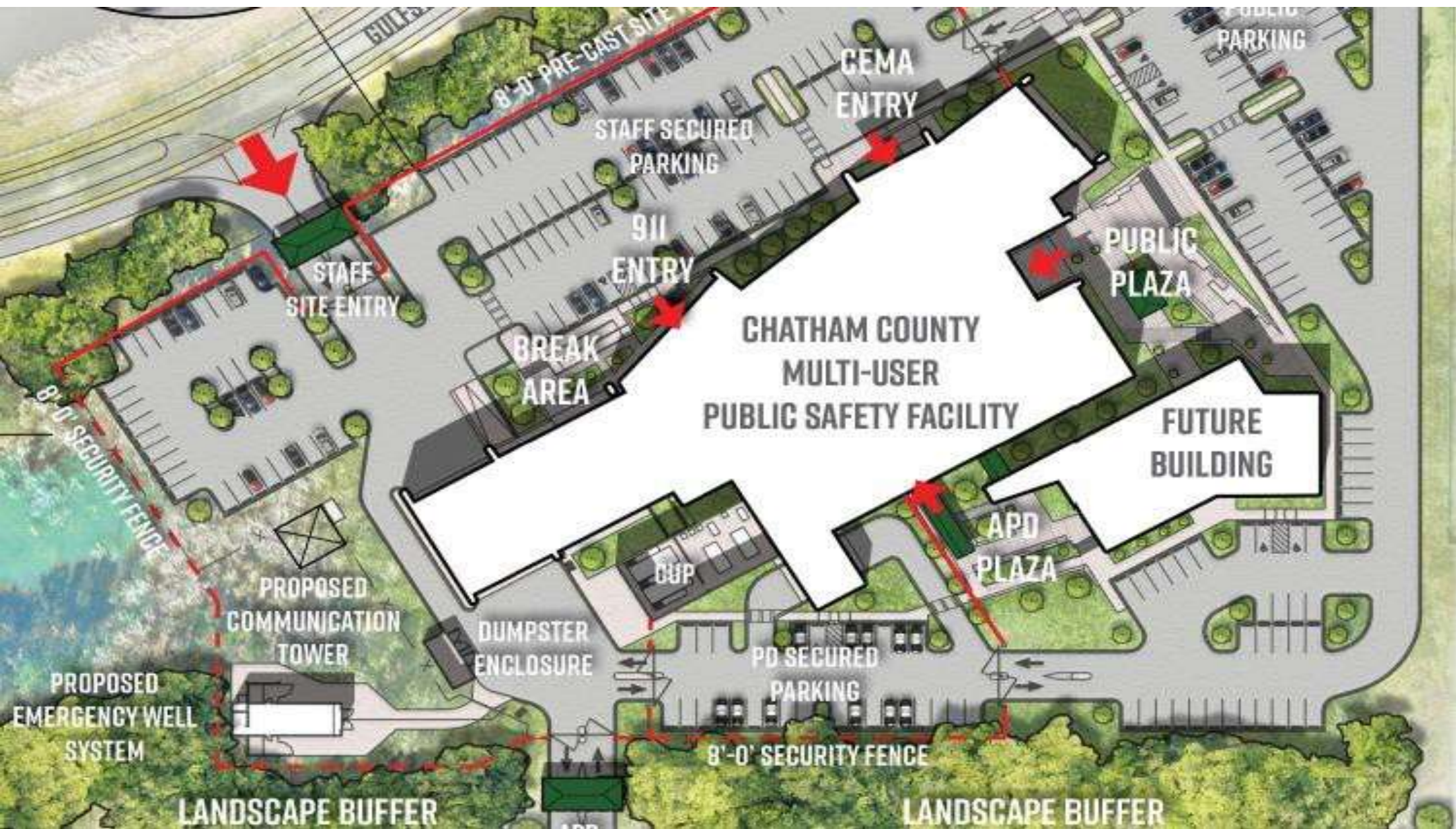

An architectural rendering of a modern, two-story building with red brick and white panels. The building features large glass windows and a central entrance with a green awning. In front of the building are three tall flagpoles with the Georgia state flag, the United States flag, and the Chatham County flag. A blue car is parked in the foreground on the right. The sky is blue with scattered white clouds.

Joint Emergency Communication & Operations Facility



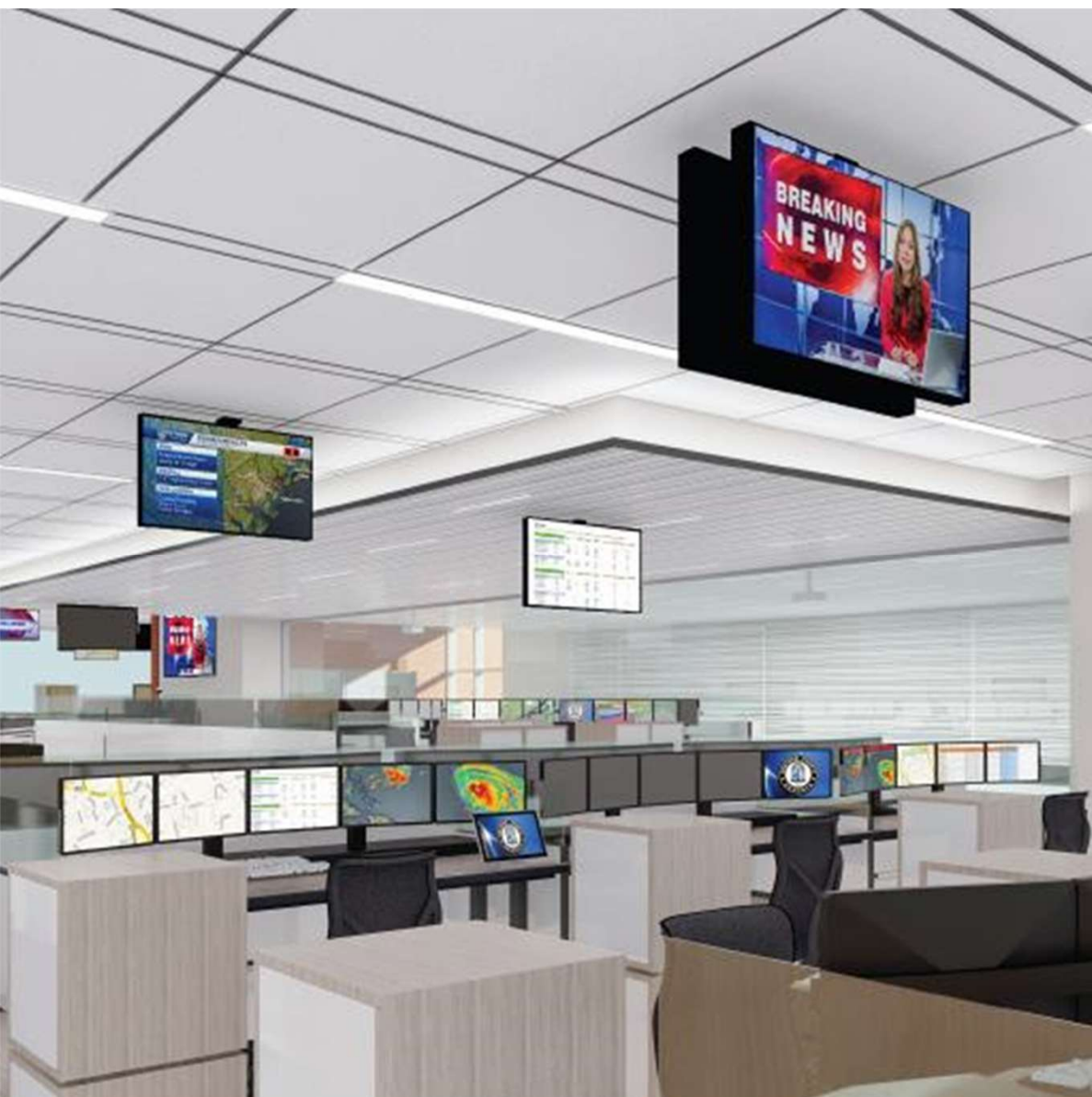

Chatham County
Workstations

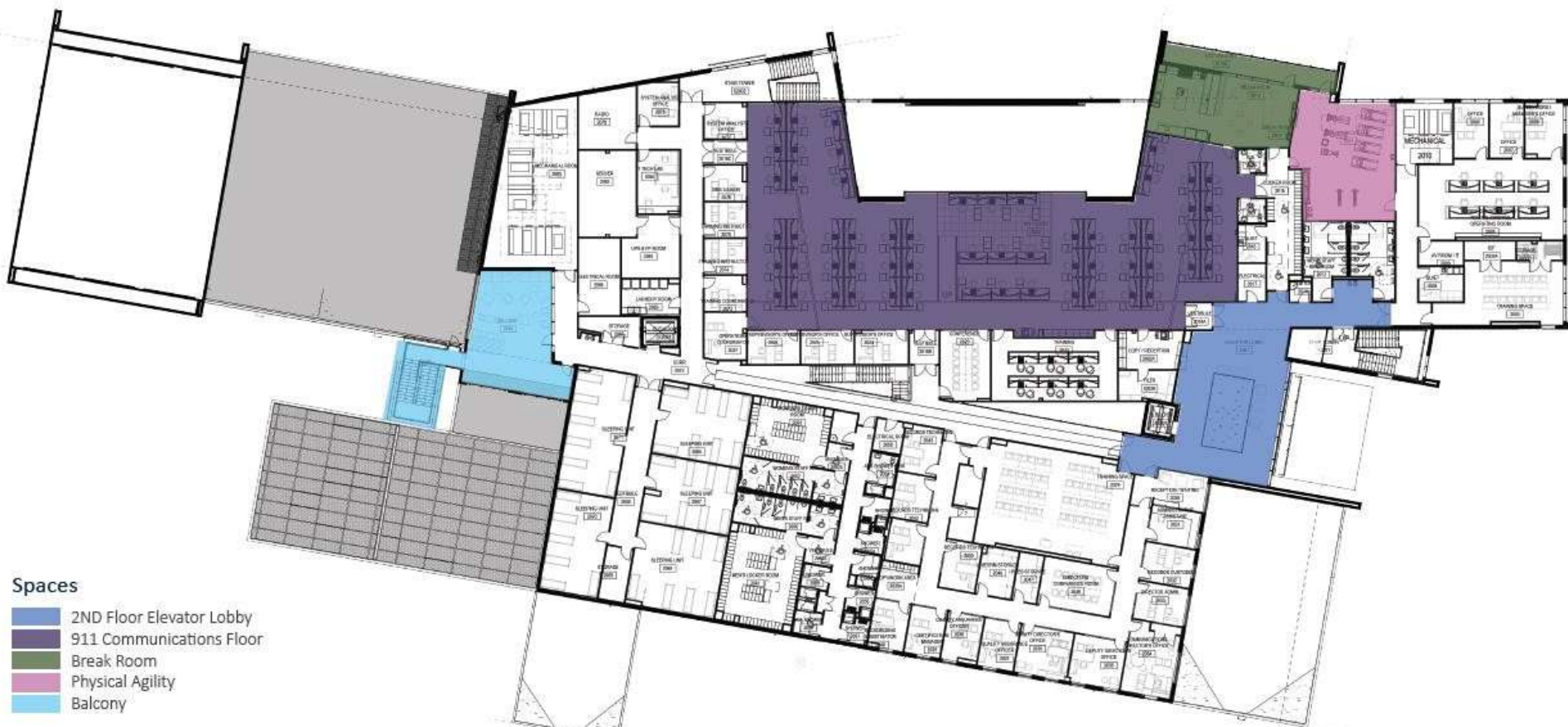

Chatham County Policy Conference Room



Contacts

Col. Ivan Bolden, Retired

- van@boldenconsultingservices.com

Chairman Chester A. Ellis

- chairman@chathamcounty.org

Col. Sheldon Wilson

- Sheldon.Wilson@us.af.mil

Tara Jennings

- tgjennings@chathamcounty.org